

1. PRODUCT NAME

PIB (Perimeter Isolation Barrier)

2. MANUFACTURER

PROFLEX® Products, Inc.
2826 Broadway Center Blvd
Brandon, Florida 33510
Telephone: 863-937-9623
Toll Free: 877-577-6353
Fax: 863-937-9624
Internet: www.proflex.us



3. PRODUCT DESCRIPTION

PROFLEX® PIB (Perimeter Isolation Barrier) is a low density polyethylene foam product. The product serves as a means to assist the installer in maintaining a 1/4" perimeter isolation space along the perimeter of a flooring installation where a change of plane occurs. (Floor to Wall).

PROFLEX® PIB is a companion product for use with PROFLEX® elastomeric membranes and underlayments. PROFLEX® PIB is used to maximize sound isolation and create a soft joint around the perimeter of wear layer installation. PROFLEX® PIB is placed along the wall surface where the flooring installation meets. The PIB may be affixed to the wall using staples or by using a double sided stick tape. Continue with your installation with the PIB in place so a 1/4" perimeter isolation space is maintained along the perimeter. Once your installation is complete, the PIB may be either trimmed away at a point flush with the flooring surface. This method is effective if installing baseboards or cove base. If the perimeter space is left exposed, the PIB may be removed and the space filled with an acoustical sealant, or matching caulk product.

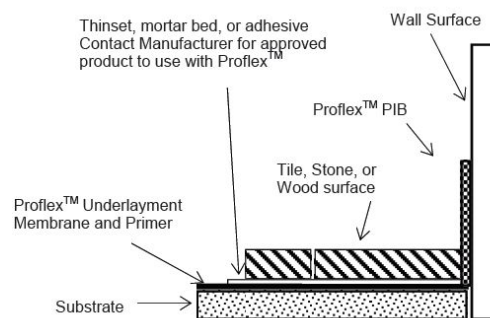

***DO NOT FILL IN THE PERIMETER SPACE WITH ANY TYPE OF GROUT OR CEMENTITIOUS PRODUCT.**

Advantages

- Will aid in the reduction of perimeter flanking noise in sound related applications. (Note: In addition to the perimeter space, the product can be used to reduce perimeter flanking noise under wall studs. Contact technical support for additional information.)
- Is suitable for use with all hard surface floor covering where sound control is needed.

Product Composition and Packaging

Low Density polyethylene closed cell foam.
1/4" x 4" x 125' rolls

4. TECHNICAL DATA

Non-applicable.

5. INSTALLATION

For further assistance with the use of this product, or any other installation related questions, please contact our technical support team at 1-877-577-6353 or visit us on the web at www.proflex.us

6. AVAILABILITY

PROFLEX® Products are available nationwide.
To locate Proflex products in your area, please contact:
Phone: 877-577-6353
Website: www.proflex.us

7. WARRANTY

For warranty related questions, please contact our technical support team at 1-877-577-6353 or visit us on the web at www.proflex.us

8. MAINTENANCE

None required, but installation performance and durability may depend on properly maintaining products supplied by other manufacturers.

9. TECHNICAL SERVICES

Information is available by calling the Technical Support

Toll Free: 877-577-6353

Fax: 863-937-9624

Technical and safety literature: To acquire technical and safety literature, please visit our website www.proflex.us

10. FILING SYSTEM

Division 9